

Electronic System of ACDS (eACDS)

The eACDS is a software including web and mobile applications to link all supply chains in one unique system implementing by all stakeholders such as fishing master, fish buyers, fish processors, importer/exporters, etc.

The system provides access to the origin of fish by importer and/or customs of importing country including consumers via the QR Code that come with the Catch Certificate and fish/fishery products.

The mobile application is uploaded to Google Play Store for Android and App Store for iOS (in 2019) as free application for registered stakeholders.



“eACDS is designed to meet the requirements of AMSs. The system supports in electronic documents, not creating unnecessary burden, cost or lengthy process for all supply chain, and importers/exporters.”

How to contact us
 Training Department
 P.O. Box97, Phrasamutchedi,
 Samut Prakan 10290, Thailand
<http://www.seafdec.or.th>

#	Regis No	Vessel Name	Engine Type	Fishing Gear	License Number	Expiry Date	Expiry Due	Action
1	B1272	SEI MUBANG	Wooden	Trawl	24094	2018-05-08	13 Days	Renew
2	B2117	HODDAA	Wooden	Trawl	24083	2018-05-07	13 Days	Renew
3	B913	OCEAN MARINE 1	Wooden	Trawl	24088	2018-05-01	13 Days	Renew
4	B1888	Gulden-10	Wooden	Purse Seine	24087	2018-05-24	10 Days	Renew
5	B3191	GENGLANG SIRE 1	FG	Purse Seine	24096	2018-05-19	10 Days	Renew



PROMOTION OF ASEAN Catch Documentation Scheme for Marine Capture Fisheries

Electronic ASEAN Catch Documentation Scheme

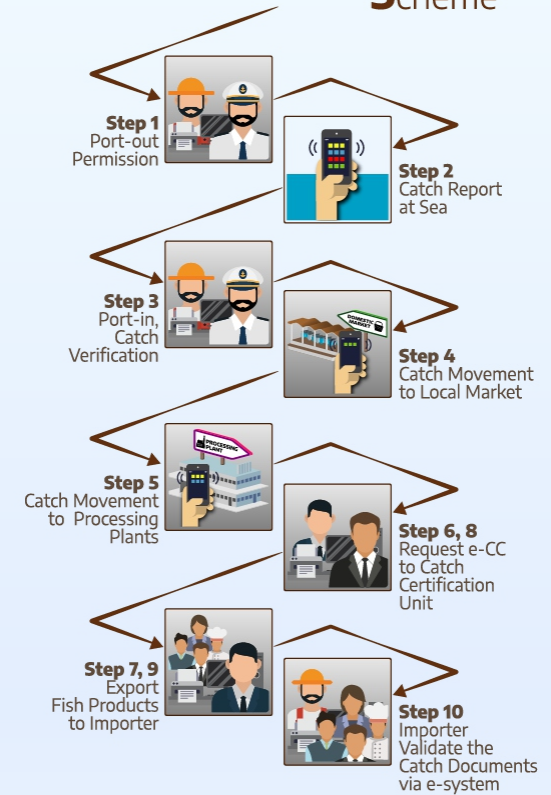

ASEAN Catch Documentation Scheme (ACDS)

SEAFDEC member countries expressed their support on the development of ACDS as a tool to prevent the entry of fish and fishery products from IUU fishing activities into the supply chain

Development of eACDS : LESSONS LEARNT

eACDS integrated good practices and lessons learnt from:

- CCAMLR, CDS for Toothfish
- SwAM/Sweden, system for EU (testing)
- FAO Guidelines on CDSs
- FMO/THAILAND : MCPD

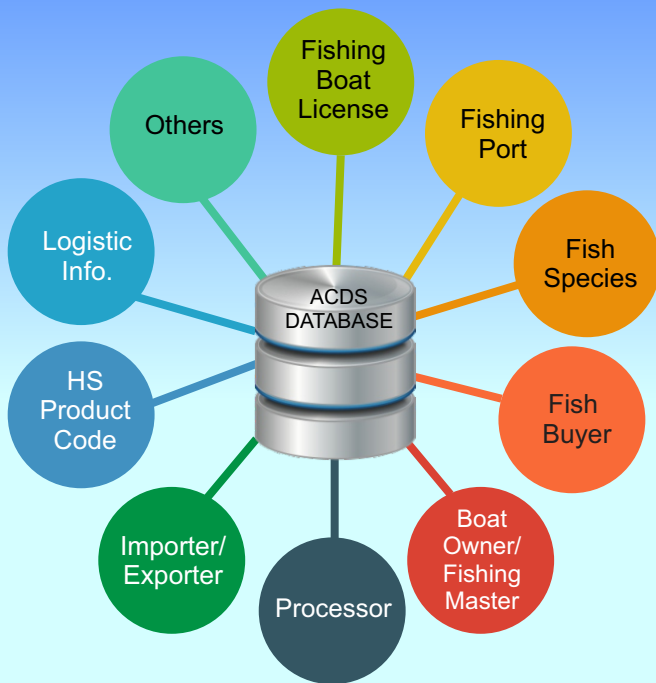

KEY DATA ELEMENTS (KDEs)

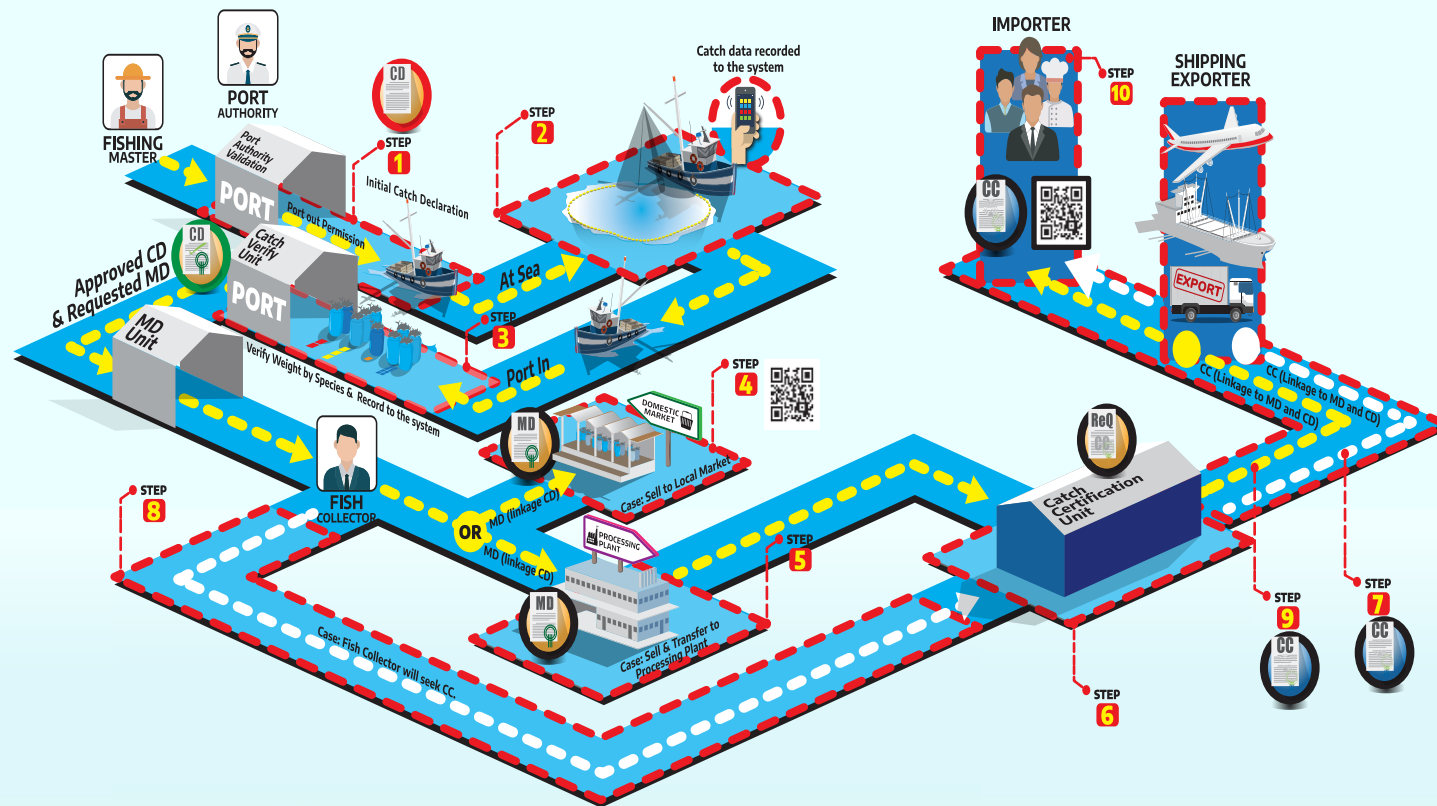

1) Catch Declaration (CD)

- Port-out control, issue initial CD and password
- Catch report at point of catch via mobile
- Port-in control, catch weight verification
- Issue the CD to fishing master

2) Movement Document (MD)

- Fish purchasing process at the landing site
- Issue the MD either to local market or processor

3) Catch Certification (CC)

- Processor request for the CC via web-based application
- The Competent Authority issues the CC for exportation
- The importer makes clearance on the CC

4) Processing Statement (PS)

- Statement created by processing plant to confirm that the processed fishery products had been obtained from catches supplied or imported

5) Re-export Certificate (RC)

- Document intended for the convenience of any AMSs fish and fishery products which had been previously imported into the AMSs for re-exportation without processing

